



ASSEMBLY INSTRUCTION

Item No.:

1430K-1 (1/3) California/Eastern King Headboard

1430K-2 (2/3) California/Eastern King Footboard & Slats

1430-3 (3/3) Eastern King/Queen Side Rails

"the first touch is on , second touch is brighter , third touch is brighter and brighter , fourth touch is off"

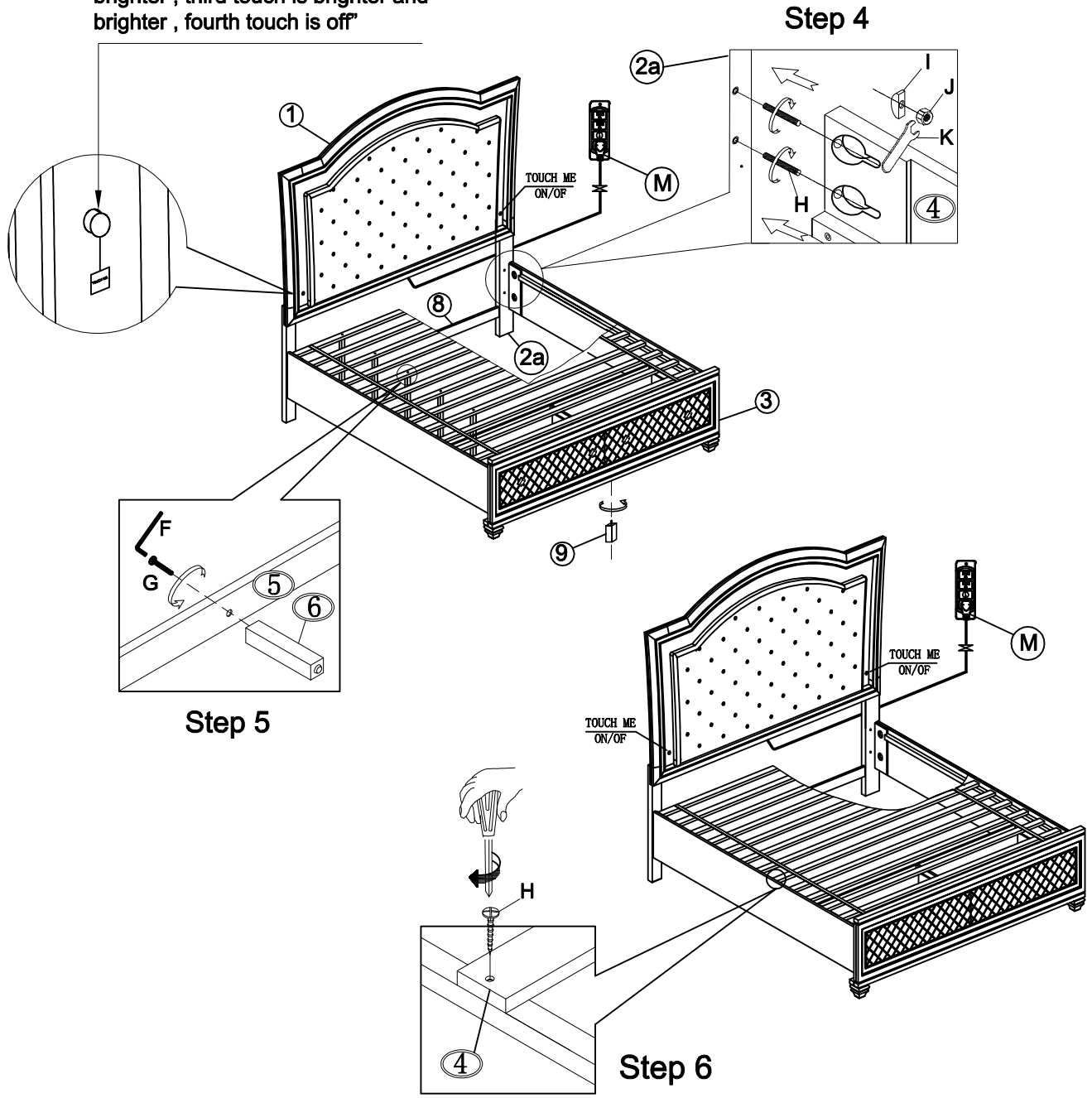

NOTE :

▲ DO NOT TIGHTEN BOLTS UNTIL COMPLETELY ASSEMBLED